



COMPACT QUIET LATCH

Series 4000, 5000 and 5005

Spring Driven Air/Water/Oil/Grease

Series 4000, 5000 and 5005 - 1/4", 3/8", 1/2" I.D.

Series 4000 and 5000 reels are all steel construction and compact for a wide range of applications with critical space requirements. A full flow shaft and swivel assures maximum product delivery. The Quiet Speed latch mechanism offers quiet operation combined with latch cam technology insuring longer latching life and trouble-free performance.

Series 5000 E reels are the same as 5000 O reels except E Series reels are fully enclosed. To order, change the model number suffix letter O to E, Example: 5430 OHP becomes 5430 EHP. Add 8 lbs. to open reel weight. Enclosed version in not available for series 5005 reels.



A5850 OLP

Made in USA

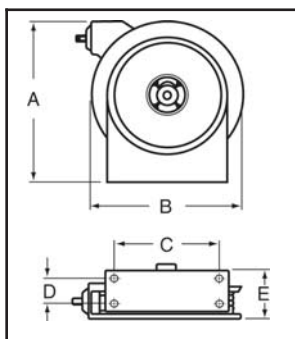

Four 5/16" (8mm) diameter mounting holes.

		DIMENSIONS							
		4000 O		5000 O		5405, 5605 and A5805		A5806	
		in / mm		in / mm		in / mm		in / mm	
A	12 7/8 327	14 1/2 368	17 1/2 445	17 1/2 445					
B	12 5/8 321	13 1/2 343	16 1/2 419	16 1/2 419					
C	8 203	9 3/4 248	9 3/4 248	9 3/4 248					
D	2 1/2 64	2 1/2 64	2 1/2 64	2 1/2 64					
E	5 3/8 136	6 152	6 152	7 179					

MODELS WITH HOSE			HOSE CAPACITY					MODELS WITHOUT HOSE		
MODEL	WEIGHT	PRESSURE	I.D.	O.D.	(M)NPTF OUTLET	(F)NPTF INLET	LENGTH	MODEL	WEIGHT	PRESSURE
	lbs / kg	psi / bar							in / mm	lbs / kg
LOW PRESSURE AIR/WATER REELS* Maximum Temperature 150° F (65° C)										
4420 OLP	17 8	300 21	1/4 6	.500 13	1/4	3/8	20 6	4400 OLP	17 8	500 35
4425 OLP	19 9	300 21	1/4 6	.500 13	1/4	3/8	25 8	4400 OLP	17 8	500 35
4435 OLP	20 10	300 21	1/4 6	.500 13	1/4	3/8	35 11	4400 OLP	17 8	500 35
5450 OLP	26 12	300 21	1/4 6	.500 13	1/4	3/8	50 15	5400 OLP	20 9	500 35
4617 OLP	19 9	300 21	3/8 10	.640 16	1/4	3/8	17 5	4600 OLP	17 8	500 35
4625 OLP	22 10	300 21	3/8 10	.640 16	1/4	3/8	25 8	4600 OLP	17 8	500 35
5635 OLP	25 12	300 21	3/8 10	.640 16	1/4	3/8	35 11	5600 OLP	21 10	500 35
5650 OLP	36 16	300 21	3/8 10	.640 16	1/4	3/8	50 15	5605 OLP	31 14	500 35
A5825 OLP	29 14	300 21	1/2 13	.781 20	1/2	3/8	25 8	A5800 OLP	22 10	500 35
A5835 OLP	38 17	300 21	1/2 13	.781 20	1/2	3/8	35 11	A5805 OLP	32 15	500 35
A5850 OLP	44 20	300 21	1/2 13	.781 20	1/2	3/8	50 15	A5806 OLP	35 16	500 35
MEDIUM PRESSURE OIL REELS** Maximum Temperature 210° F (99° C)										
5435 OMP	31 14	2750 190	1/4 6	.530 14	1/4	3/8	35 11	5400 OMP	26 12	3000 207
5630 OMP	30 14	2250 155	3/8 10	.780 20	3/8	3/8	30 9	5600 OMP	23 11	3000 207
A5825 OMP	31 14	2000 138	1/2 13	.820 21	1/2	3/8	25 8	A5800 OMP	32 15	3000 207
A5835 OMP	42 19	2000 138	1/2 13	.820 21	1/2	3/8	35 11	A5805 OMP	32 15	3000 207
HIGH PRESSURE GREASE REELS*** Maximum Temperature 210° F (99° C)										
5430 OHP	30 14	5000 345	1/4 6	.590 15	1/4	1/4	30 9	5400 OHP	23 11	5000 345
5435 OHP	42 19	5000 345	1/4 6	.590 15	1/4	1/4	35 11	5405 OHP	31 15	5000 345
5625 OHP	31 14	4000 276	3/8 10	.750 19	1/4	1/4	25 8	5600 OHP	26 12	5000 345

*Low pressure hose reels furnished standard with PVC hose. Compressed air hoses should not be converted to oxygen service - may cause explosion when O₂ mixes with fuel. **Medium pressure reels furnished standard with S.A.E. 100 R1T one wire braid hose. ***High pressure reels furnished standard with S.A.E. 100 R2T two wire braid hose, suitable for grease applications only. See page 49 for optional mounting bases and brackets. See page 51 for inlet hose assemblies and adjustable bumper stops.

North America: 800-444-3134 Asia: +63 (45) 625-6624
 Europe: +44 (0) 1536 406999 Latin America: 260-489-1685

www.reelcraft.com



REELCRAFT

Wind Things Up With Reelcraft™