



Fry's Napa AutoCare Center, Columbia City, IN



7850 OLP

### Spring Driven Air/Water/Oil/Grease Series 7000 - 1/4", 3/8", 1/2", 3/4" I.D.

Series 7000 is very robust and ideal for the most demanding applications. The reel's base and guide arms are formed from high-grade steel and engineered with structural forms and gussets to yield the greatest amount of strength. The standard low pressure hose is for air or water service only. The basic reel without hose can be used for air, water or oil. Consult Reelcraft for other products and hoses.

Made in USA



INSET:  
ENCLOSED MODEL

7650 ELP

#### APPLICATIONS

- Industrial
- Automotive Service Centers
- Transmission Shops
- Fleet Maintenance Facilities
- Pneumatic Tools
- Aircraft Maintenance
- Tire Stores
- Agriculture
- Farm and Ranch
- Service Trucks
- Wash Down
- Air and Water

Series 7000 E reels are the same as 7000 O reels except **E Series reels are fully enclosed**. To order, change the model number suffix letter O to E. Example, 7650 OHP becomes 7650 EHP. Add 17 lbs. to open reel weight.

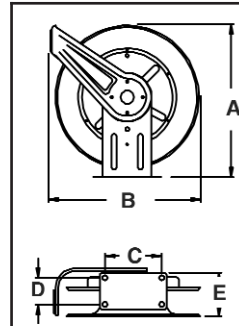

#### DIMENSIONS

	7000 O		7000 E	
	in	mm	in	mm
A	20 1/4	521	20 3/4	527
B	19	483	20 3/4	527
C	7 7/8	200	7 7/8	200
D	3 7/8	98	3 7/8	98
E	7	178	8	204

Four 1/2" (12.7mm) diameter mounting holes.

For all metric thread connections over 1/2" add the suffix number 70 to indicate BSPT threads - example 7900 OLP70.

MODELS WITH HOSE				HOSE CAPACITY					MODELS WITHOUT HOSE		
MODEL	WEIGHT	PRESSURE	I.D.	O.D.	(M)NPTF OUTLET	(F)NPTF INLET	LENGTH	MODEL	WEIGHT	PRESSURE	
	lbs / kg	psi / bar	in / mm	in / mm	in	in	ft / m		lbs / kg	psi / bar	
LOW PRESSURE AIR /WATER REELS* Maximum Temperature 150° F (65° C)											
7650 OLP	47 22	300 21	3/8 10	.688 18	1/4	1/2	50 15	7600 OLP	42 19	500 35	
7670 OLP	50 23	300 21	3/8 10	.688 18	1/4	1/2	70 22	7600 OLP	42 19	500 35	
7850 OLP	51 24	300 21	1/2 13	.844 22	3/8	1/2	50 15	7800 OLP	43 20	500 35	
7850 OLP121	51 24	300 21	1/2 13	.844 22	1/2	1/2	50 15	7800 OLP	43 20	500 35	
7925 OLP	49 22	250 17	3/4 19	1.188 31	3/4	3/4	25 8	7900 OLP	44 20	500 35	
F7925 OLP§	53 24	50 3.5	3/4 19	1.188 31	3/4	3/4	25 8	F7900 OLP	45 21	500 35	
MEDIUM PRESSURE OIL REELS** Maximum Temperature 210° F (99° C)											
7650 OMP	55 25	2250 158	3/8 10	.690 18	1/2	1/2	50 15	7600 OMP	45 21	3000 207	
7850 OMP	57 26	2000 141	1/2 13	.815 21	1/2	1/2	50 15	7800 OMP	42 19	3000 207	
HIGH PRESSURE GREASE REELS*** Maximum Temperature 210° F (99° C)											
7450 OHP	57 26	5000 345	1/4 6	.590 17	1/4	1/2	50 15	7400 OHP	43 20	5000 345	
7650 OHP	60 27	4000 276	3/8 10	.750 19	1/4	1/2	50 15	7600 OHP	46 21	5000 345	

\*Low pressure reels furnished standard with PVC hose. \*\*Medium pressure reels furnished standard with S.A.E. 100 R1T one wire braid hose.

\*\*\*High pressure reels furnished standard with S.A.E. 100 R2T Two wire braid hose, suitable for grease or hydraulic oil applications only.

§ Series F7925 OLP supplied with fuel grade hose and UL330 and UCL approved hose with a 250 psi (17 bar) minimum burst.

See page 51 for inlet hose assemblies and adjustable bumper stops. See page 49 for optional mounting bases and brackets.

North America: 800-444-3134 Asia: +63 (45) 625-6624  
Europe: +44 (0) 1536 406999 Latin America: 260-489-1685

www.reelcraft.com

Reelcraft Industries is  
ISO 9001:2000  
Certified Since 1996

Models listed with an icon can be shipped same day upon request when the order is received by 11:30 AM local time for quantities of 5 or fewer.

IN Indiana Warehouse CA California Warehouse  
CA Indiana & California Warehouses CA Canadian Warehouse